

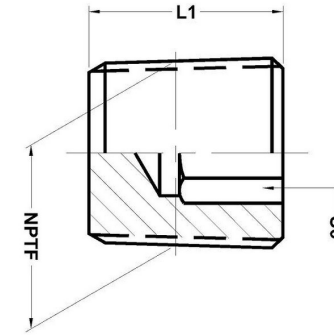

HYDROMATIK
connections par excellence

Metric Bite Type Fittings

GP-N - GRUB PLUG GP-N | Male Thread - NPTF (SAE J476)



Part No.	NPTF	L1	S6
GP 1/8 NPT	1/8-27	8	5
GP 1/4 NPT	1/4-18	12	6
GP 3/8 NPT	3/8-18	12	8
GP 1/2 NPT	1/2-14	16	10
GP 3/4 NPT	3/4-14	16	14
GP 1 NPT	1-11.5	20	14
GP 1 1/4 NPT	1 1/4-11.5	20	25.4
GP 1 1/2 NPT	1 1/2-11.5	20	30
GP 2 NPT	2-11.5	21	30