

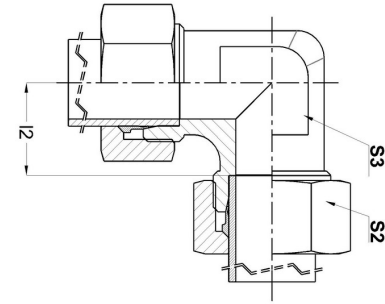

HYDROMATIK
connections par excellence

Metric Bite Type Fittings

E - EQUAL ELBOW E |



Part No.	Series	Tube OD	S2	S3	l2
E 06-L	Light-250 Bar	6	14	12	12
E 08-L	Light-250 Bar	8	17	12	14
E 10-L	Light-250 Bar	10	19	14	15
E 12-L	Light-250 Bar	12	22	17	17
E 15-L	Light-250 Bar	15	27	19	21
E 18-L	Light-160 Bar	18	32	24	23.5
E 22-L	Light-160 Bar	22	36	27	27.5
E 28-L	Light-100 Bar	28	41	36	30.5
E 35-L	Light-100 Bar	35	50	41	34.5
E 42-L	Light-100 Bar	42	60	50	40
E 06-S	Heavy-630 Bar	6	17	12	16
E 08-S	Heavy-630 Bar	8	19	14	17
E 10-S	Heavy-630 Bar	10	22	17	17.5
E 12-S	Heavy-630 Bar	12	24	17	21.5
E 14-S	Heavy-400 Bar	14	27	19	22

E 16-S	Heavy-400 Bar	16	30	24	24.5
E 20-S	Heavy-400 Bar	20	36	27	26.5
E 25-S	Heavy-400 Bar	25	46	36	30
E 30-S	Heavy-250 Bar	30	50	41	35.5
E 38-S	Heavy-250 Bar	38	60	50	41

Dimensions given approx. Fig. with tightened nut.

Part No. Given refers to complete assembly - Steel Part